

Special Order Worksheet

Enter dimensions only if different from those shown in catalog.

Date Ordered: \_\_\_\_\_

Customer: \_\_\_\_\_ Part #: \_\_\_\_\_

P.O. #: \_\_\_\_\_ Quantity: \_\_\_\_\_ Ship Date: \_\_\_\_\_

Actual Header Size: \_\_\_\_\_ Actual Joist Size: \_\_\_\_\_ Example: nominal 2x4 = 1.5" x 3.5" actual size, 6 x 10 rough = 6" x 10" actual size

Specialty Options	Circle One	Angle	Type of Connection	Ordering Designation Suffix
<b>Sloped Seat</b> (45° Max.)	Up or Down	_____	Fig. 1, 3, & 5	Example: <i>_SL30D</i>
<b>Skewed</b> HWUH 45° Max. PHXU 60° Max. Other series 84° Max.	Left or Right	_____	Fig. 2, 3, & 5	Example: <i>_SK45R_BV</i> or <i>_SK45R_SQ</i>
	Cut Type A = Beveled (BV) Cut Type B = Square (SQ)		Fig. 2	
<b>Joist Flush with Header at</b> Default to low side flush unless specified	Low Side Center High Side	<b>Caution:</b> A joist with both slope and skew will project above the header when the height is measured from the low side.	Fig. 3 & 6	Example: <i>_SK45R_BV_SL30D</i>
<b>Sloped Top Flange</b> (35° Max.) Except HWUH series	Left or Right	_____	Fig. 5, 6, & 8	Example: <i>_SLTF30L</i>
<b>Top Flange Offset</b> Note: PHXU series will be welded with a closed top angle, not formed	Left or Right	_____	Fig. 7	Example: <i>_OSL</i>
<b>Saddle - SPECIFY:</b> W1 Joist Size _____ H1 _____ SA _____ W2 Joist Size _____ H2 _____			Fig. 4	Example: <i>_SA=5-1/2"</i>
<b>Ridge</b> (45° Max.) Except HWUH & PHXU series	Center Left Side Right Side		Fig. 8	Example: <i>_DA30</i>
<b>Catalog Load OK?</b>	Yes or No	If NO, load required: _____		

Notes

Internal Use Only

Signature: \_\_\_\_\_

Fig. 1 - Sloped seat, down shown

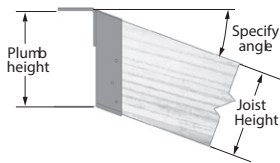

Fig. 2 -

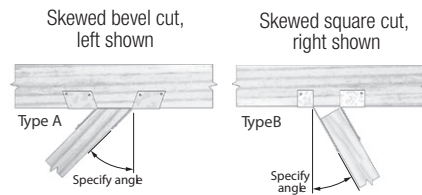

Fig. 3 - Sloped down, skewed right, low side flush shown

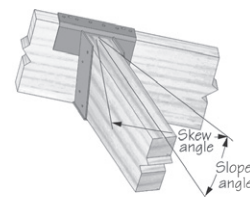

Fig. 4 - Saddle option

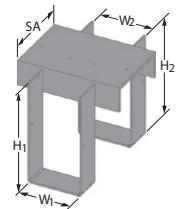

Fig. 5 - Skewed right, sloped down, top flange sloped

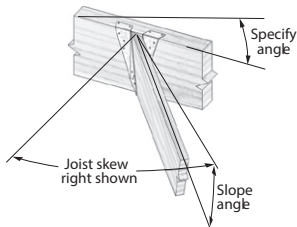

Fig. 6 - Sloped top flange, right shown

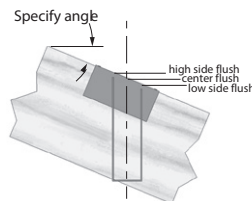

Fig. 7 - Top flange offset, right shown

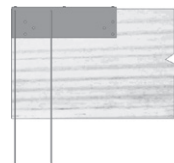
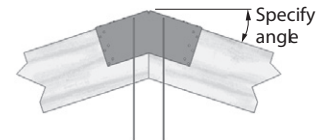

Fig. 8 - Ridge, top flange sloped



MiTek Structural Connectors has designed this product based on specifications submitted by customer. If actual conditions are different than those submitted, MiTek shall not assume liability for loads or installation issues. MiTek recommends a design professional verify suitability of connector to meet the design requirements as submitted.

Phone: 1-800-328-5934 • Fax: 1-952-898-8605 • Email: customerservice@mii.com