

### Surface Preparation and Cartridge Set Up

Incredi-Bond is an ideal bonding agent to multiple surfaces including concrete, brick, wood, stone, block and metal. Surfaces must be cleaned and profiled or textured. New concrete must be a minimum of 28 days old. All dirt, oil, debris, wax, grease or dust must be removed. Prepare the surface mechanically using a scarifier, sandblast, shotblast, bushhammer or other equipment that will give the surface profile needed for the application. A roughened surface is imperative for good adhesion.

- Always be sure the bonding surfaces are prepared in advance before starting a new cartridge or mixing product. If at all possible, schedule dispensing to consume an entire cartridge at one time with no interruption of epoxy flow.
- When bonding two surfaces together, make sure to completely fill all the gaps between the mating surfaces.
- To achieve maximum flow and reduce fatigue, the tip of the nozzle can be snapped off at the narrowest point of the nozzle.

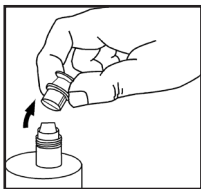

**I.** Remove plastic cap and plug from threaded end of cartridge.

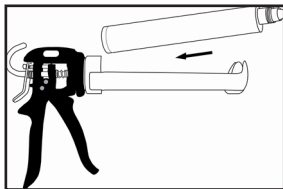

**II.** Place cartridge into dispensing tool, MiTek's HDT-10 is recommended.

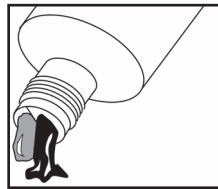

**III.** Dispense small amount of adhesive into a disposable container until both flow from cartridge.

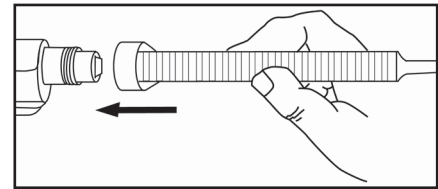

**IV.** Attach mixing nozzle to cartridge and dispense a small amount of material into same waste container until a consistent color with no streaks is obtained.

### SPALL Patching Applications

**WARNING:** Use Incredi-Bond for **SMALL SPALL REPAIRS ONLY**. A deeper or larger mass than recommended will generate excessive heat resulting in undesirable reactions such as bubbling and cracking.

For Incredi-Bond, the spall should be ground to a depth of 1/2" (1.27cm) to 5/8" (1.6cm) deep and width no greater than 3" (7.6 cm). Avoid a feathered edge by cutting around the spall into sound concrete with a grinder or circular saw using a diamond or concrete abrasive blade so the entire depth of the spall is consistent. Follow surface preparation instructions above to clean spall area. For patching concrete or wood surfaces, fill the void with the Incredi-Bond epoxy to just above the surface level and trowel flush.

**Safety Note:** Component (A) contains epoxy resin and is an irritant / sensitizer; component (B) contains amines and is a corrosive / sensitizer; prior to using the epoxy material, please consult the material safety data sheet for proper handling instructions. Always wear protective safety glasses and gloves when working with epoxies and chemicals.

**Coverage:** The 8.6 oz (254 ml) cartridge will yield approximately 19 linear feet (5,7 m) when drawing a 1/4" x 1/4" (.64 x .64 cm) bead. When used as a capping material for crack injection estimate roughly 4-6 linear feet per cartridge. The quart kit will yield approximately 0.30 sq. ft. (290 cm<sup>2</sup>) at 1 inch depth (2.54 cm).