

1. THIS REPAIR IS TO BE USED FOR SINGLE PLY TRUSSES IN THE 4X\_ ORIENTATION ONLY.
2. MINIMUM CHORD LUMBER SPECIFIC GRAVITY = 0.42 (SPF)
3. MAXIMUM LENGTH OF NOTCH IS 6".
4. NO LUMBER DEFECTS WITHIN +/- 12" OF NOTCH.
5. THE END DISTANCE, EDGE DISTANCE, AND SPACING OF NAILS SHALL BE SUCH AS TO AVOID SPLITTING OF THE WOOD.
6. CONNECTOR PLATES MUST BE FULLY IMBEDDED AND UNDISTURBED.
7. THIS IS A SPECIFIC REPAIR DETAIL TO BE USED ONLY FOR ITS ORIGINAL INTENTION. THIS REPAIR DOES NOT IMPLY THAT THE REMAINING PORTION OF THE TRUSS IS UNDAMAGED. THE ENTIRE TRUSS SHALL BE INSPECTED TO VERIFY THAT NO FURTHER REPAIRS ARE REQUIRED. WHEN THE REQUIRED REPAIRS ARE PROPERLY APPLIED, THE TRUSS WILL BE CAPABLE OF SUPPORTING THE LOADS INDICATED.
8. FOR FORCES OR NOTCH SIZE THAT EXCEED MAXIMUM, SEE ST-CUT FOR REPAIR DETAIL.

REFER TO INDIVIDUAL TRUSS DESIGN FOR PLATE SIZES, LUMBER GRADES AND FORCE IN PANEL TO BE REPAIRED. APPLICABLE FOR WOOD OR METAL WEB TRUSSES.

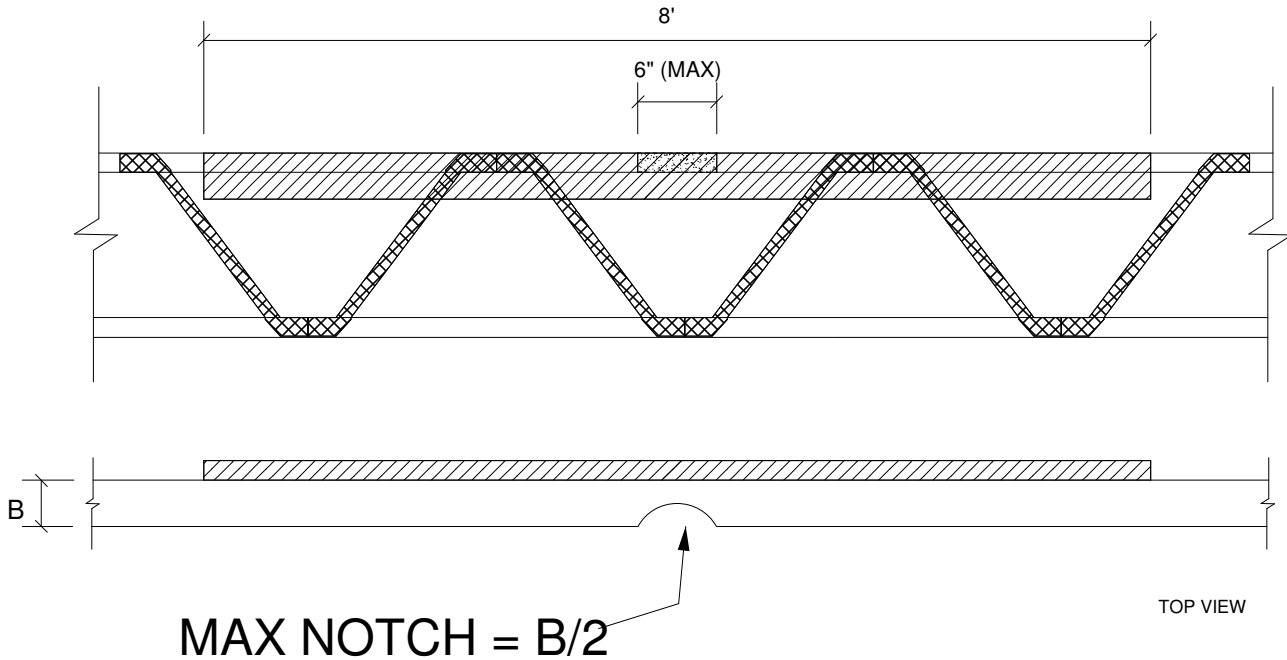

APPLY 2X4X8' SCAB TO ONE SIDE OF TRUSS CENTERED ON NOTCH WITH CONSTRUCTION QUALITY ADHESIVE AND 1 ROW OF 10d (0.131" X 3") NAILS SPACED 3" O.C. SCAB GRADE AND SPECIES TO MATCH EXISTING CHORD.

MAXIMUM ALLOWABLE CHORD FORCE AT NOTCH LOCATION	
SP	2968
SPF	2296
DF	2716
HF	2352