



1. MARK BASE MATERIAL

→ Mark the location of the two large holes for either mechanical or chemical anchoring, or use the four smaller holes for concrete screws.



2. INSTALL ANCHORS

→ Washers should be used for all concrete anchors.
 → Anchors to be designed by others and installed per manufacturers specifications.

Loads may be limited by the manufacturer's anchorage.

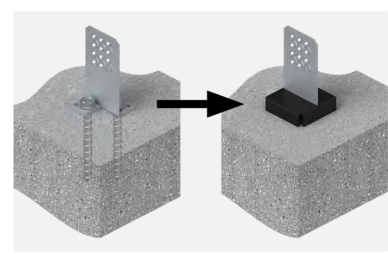

3. ASSEMBLE STAND-OFF PLATE

→ Slide stand-off plate over the knife plate and let it rest on the concrete.

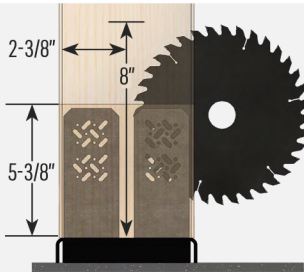

4. CUT AND INSTALL POST

→ 1/8" wide cut
 → 5-3/8" from the end of the post
 → 8" from the bottom of a post for a 7-1/4" circular saw
 → 2-3/8" deep on the 6x6 and 8x8 models, through fully for CPBQ44-TZ.

Image shows CPBQ66-TZ (CPBQ88-TZ Similar)

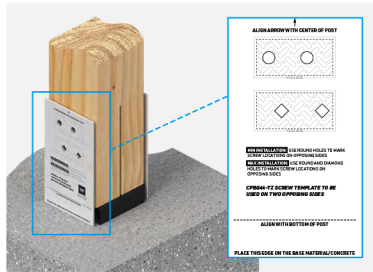

5. USE TEMPLATE

→ Align template with the center of the post and rest on the main member.
 → Mark screw locations onto post.

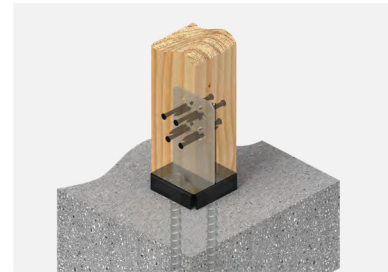

6. INSTALL SCREWS

→ Predrilling recommended with 5/32" bit, up to but not through knife plate.
 → Drive CCWS screws with a T25* bit from each side.
 → The mesh design in the knife plate will grab the screw, locking the post into place and resisting uplift and lateral loads.

*T25 is a trademark of Acument