

- Weld sizes and lengths shown on table.
  - Weld-on applications produce maximum allowable load listed. **Uplift loads do not apply to this application.**
  - All welding should be done in accordance with the American Welding Society (AWS) Standard by a certified welder.
- Caution: Welding galvanized steel may produce harmful fumes and should only be performed in well-ventilated environments.**

Top Angle Weld Length Table

MiTek Welded Hanger Series	Minimum Weld Length
SW	3"
FWHL	3-1/2"
BPHA, FWH, HBPH, PHM, SWH	4"
FWHBP, FWHFM, FWHH, KLB, KHW, PHXU	6"
KB, KGB, KHGB, KHGB, KGLS, KGLST, KGLT, KHGLS, KHGLST	8"
HLBH, KHGLT	10"

Top Angle Steel Gauge	Weld Size
14 - 10 gauge	1/8"
7 gauge	3/16"
3 gauge	1/4"

Weld shall be distributed evenly.

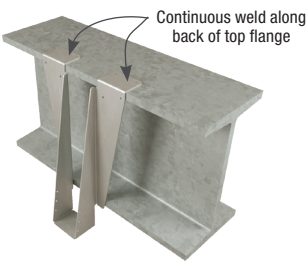

Typical top flange welded installation

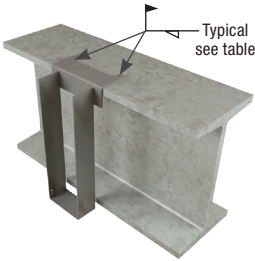

Typical top angle welded installation