

INSTALLATION GUIDE

**PRE-SLOPED SHOWER PAN**

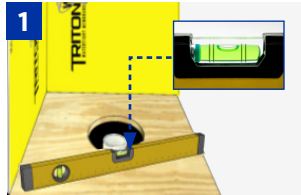

Prior to installation of MiTek Pre-Sloped Shower Pan, floor must be level and traditional clamping drain must be properly installed.

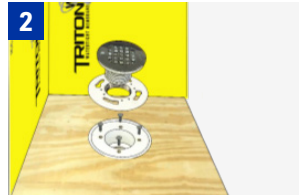

Remove 4 drain base bolts, locking collar, and adjustable drain barrel.

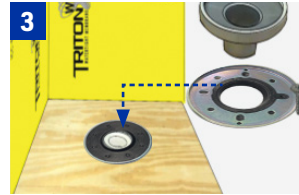

Attach adaptive drain base using the 4 bolts from step 2.

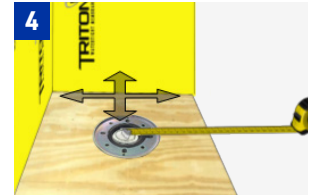

To cut Pre-Sloped Shower Pan, measure from drain center to each edge. Cut with utility knife or circular saw. Put the pan adapter back onto the pan.



Dry fit pan to ensure good fit. Leave pan adapter attached to back of pan.



Using 1/4" square notch trowel, apply approved mortar to subfloor and back of Pre-Sloped Shower Pan.



Fit Pre-Sloped Shower Pan into fresh mortar and apply pressure to ensure pan is well embedded.

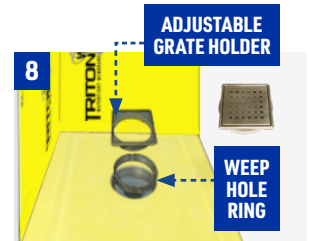

Rotate weep hole ring until flush with pan. Plastic grate holder is height adjustable to tile thickness.

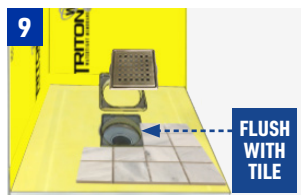

Apply MiTek Adhesive Sealant to four corners of plastic grate holder prior to fitting grate tray.



Ensure that all seams have a min. 2" overlap of MiTek Waterproof Membrane fabric or Seam Tape adhered with mortar.

MiTek Pre-Sloped Shower Pan is to be used only as part of a full MiTek Watertight System installation.