



Design of Backer Blocking for MiTek Connectors and Trusses

Backer blocking is used when a supporting members thickness is less than the length of fastener specified in official MiTek literature. The purpose of this guide is to help the designer by specifying nail/screw quantities and minimum spacing distances. Backer blocking should be of the same species of lumber as the main member. The height of the backer blocking must be equal-to or greater-than the height of the hanger. When the backer block spans multiple connection points, and a splice in the backer block is required it should be placed between two connections.

For hangers installed with nails, attach backer block with a minimum of (8) - 10d common (0.148" x 3") nails. For hangers installed with MiTek Wood Screws (WS), attach backer block with one WS3 screw for every two WS screws attaching the hanger to the supporting member. For hangers installed with 16d common (0.162" x 3.5") nails using a backer block, the allowable load is reduced 15 percent.

Note: Backer block nails or screws can be installed from either face and should be split evenly between each side of connection. Backer blocking should be of adequate length to meet minimum distances as shown below.

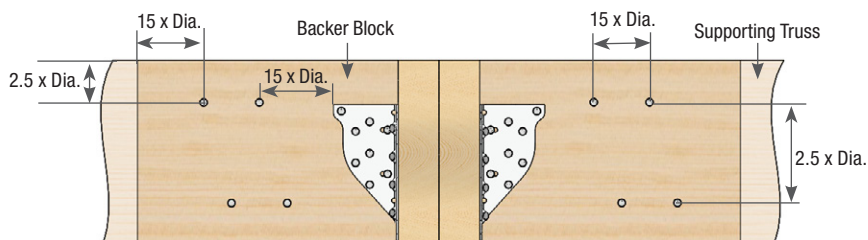
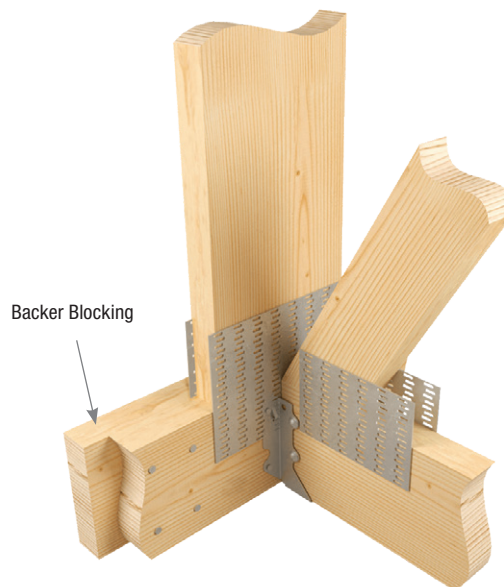

Nail Backer Block Distances

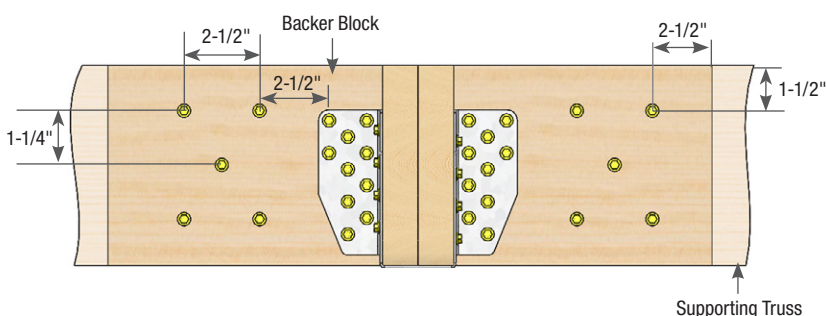

Screw Backer Block Distances

End Distance: 15 x Diameter (Dia.)
 Edge Distance: 2.5 x Dia.
 Spacing Between fasteners in a Row: 15 x Dia.
 Spacing Between staggered rows: 2.5 x Dia.

Nail spacing per 2018 NDS

Note: Dimensions on the figure are minimums and may not be to scale

End Distance: 2-1/2"
 Edge Distance: 1-1/2"
 Spacing Between fasteners in a Row: 3"
 Spacing Between staggered rows: 1-1/4"

Spacing per ICC-ESR #2761

Note: Dimensions on the figure are minimums and may not be to scale

Example: The THDHQ28-2 shown above has (20) WS3 screws connecting it to the supporting truss. Using the instructions detailed above, (10) WS3 screws must be attached from the supported truss to the backer block to be in compliance with the instructions above to support the applied allowable load of the THDHQ28-2.

Customer Service & Technical Assistance

Phone: 1-800-328-5934 • Fax: 1-952-898-8605 • Email: customerservice@mii.com

MiTek-US.com