

# Fire Wall Hangers for Beams and Purlins

## FWHBP series

MiTek has expanded the FWH Fire Wall Hanger series to include the higher load carrying capacity FWHBP, the Fire Wall Hanger for Beams and Purlins. The FWHBP transfers the load into the supporting wall thru bearing on the top plates and directly attaching to the stud pack or post below. As with the FWH hanger, the advanced design allows you to install the hangers before the gypsum wallboard (drywall) is attached, allowing your project to be completely framed-up and weather-tight before the gypsum wallboard sheathing shows up on site.

**Materials:** 12 gauge

**Finish:** Primer

**Patents:** U.S. Patent No. 10,179,992

**Options:** See current catalog for options

**Installation:**

- Install the face of hanger flanges tight to stud wall framing.
- The end of the truss/joist should measure 1-5/8" from the face of the supporting wall.
- The truss/joist should bear fully on the FWH seat with a gap no greater than 1/8" between the end of the supported member and the hanger.
- **Gypsum Wallboard Installation** - Use the FWH-T template to slot cut the gypsum wallboard. See FWH-T Template Sequence. Slide the gypsum wallboard into position and fasten to the framing members meeting the minimum requirements specified by code.

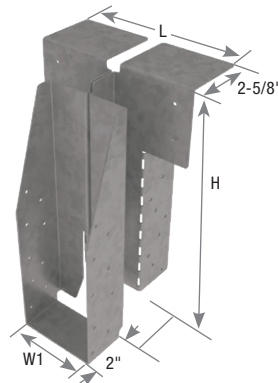

**FWHBP Hanger**

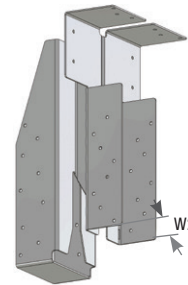

**FWHBP Stud Pack Width**

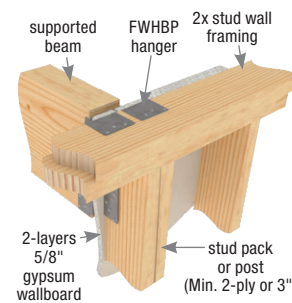
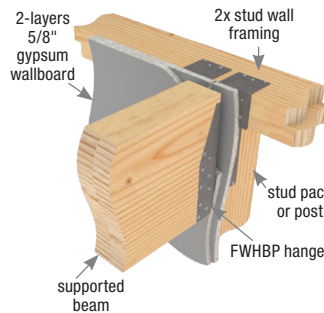

**Typical FWHBP attachment to top plate/beam and stud pack/post**

**FWH-T Template Installation Sequence**

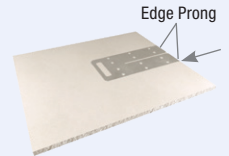

1) Align the FWH-Template slot with the mark in the gypsum wallboard and engage the prongs into edge of gypsum wallboard

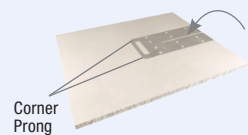

2) Rotate the template and press down on the end to engage the corner prongs

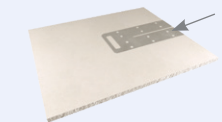

3) Run the gypsum wallboard cutter down the template to cut the slot

Joist Size	MiTek Stock No.	Ref. No.	Steel Gauge	Dimensions (in)				Fastener Schedule <sup>5</sup>						DF/SP Allowable Loads (Lbs.)						
				W1	W2 <sup>3</sup>	H	L <sup>4</sup>	Header			Joist			Download			Uplift <sup>2</sup>	Ctn Qty		
								Top Qty	Face Qty	Stud Qty	Type	Qty	Type	100%	115%	125%				
3-1/2 x 11-7/8	FWHBP35118					11-7/8														
3-1/2 x 14	FWHBP3514					13-15/16														
3-1/2 x 16	FWHBP3516					15-15/16														
3-1/2 x 18	FWHBP3518	--	12	3-9/16	Specify	17-15/16	7-1/8	6	4	16	10d	18	10d	7055	7355	7550	<b>3045</b>			
3-1/2 x 20	FWHBP3520					19-15/16														
3-1/2 x 22	FWHBP3522					21-15/16														
3-1/2 x 24	FWHBP3524					23-15/16														
5-1/4 x 11-7/8	FWHBP52118																			
5-1/4 x 14	FWHBP5214					13-15/16														
5-1/4 x 16	FWHBP5216					15-15/16														
5-1/4 x 18	FWHBP5218	--	12	5-3/8	Specify	17-15/16	7-15/16	6	4	16	10d	18	10d	<b>8005</b>	<b>8005</b>	<b>8005</b>	<b>3045</b>	1		
5-1/4 x 20	FWHBP5220					19-15/16														
5-1/4 x 22	FWHBP5222					21-15/16														
5-1/4 x 24	FWHBP5224					23-15/16														
7 x 11-7/8	FWHBP71118																			
7 x 14	FWHBP7114					13-15/16														
7 x 16	FWHBP7116					15-15/16														
7 x 18	FWHBP7118	--	12	7-1/8	Specify	17-15/16	9-11/16	6	4	16	10d	18	10d	<b>5660</b>	<b>5660</b>	<b>5660</b>	<b>3045</b>			
7 x 20	FWHBP7120					19-15/16														
7 x 22	FWHBP7122					21-15/16														
7 x 24	FWHBP7124					23-15/16														



**FWH-T template**  
(must be ordered separately)

1) Download allowable load is for a 2-Ply Top Plate with stud pack (or post) below without wall and floor sheathing attached.

2) Uplift loads have been increased 60% for wind or seismic loads. No further increase shall be permitted.

3) "Specify" denotes required stud pack/post width must be specified when ordering. Minimum 3" for a 2-ply 2x stud pack.

4) Length "L" applies where "W2" equals 3-1/8" for 2-ply stud pack. Larger "W2" widths will result in a larger length "L".

5) **NAILS:** 10d nails are 0.148" dia. x 3" long.

New products or updated product information are designated in blue font.