

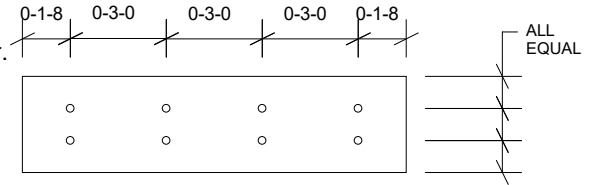

REFER TO INDIVIDUAL TRUSS DESIGN FOR PLATE SIZES AND LUMBER GRADES

**IMPORTANT**

This detail to be used only with one ply trusses with a D.O.L. lumber increase of 1.15 or higher. Trusses not fitting these criteria should be examined individually.



NAIL PATTERN FOR 2x4  
SIMILAR FOR 2x6 OR 2x8

**0-5-8 ACTUAL BEARING SIZE**

BOTTOM CHORD SIZE AND NAILING PATTERN	LUMBER SPECIE	ALLOWABLE REACTION (lb) CASE 1 <sup>1</sup>	ALLOWABLE REACTION (lb) CASE 2 <sup>4</sup>	ALLOWABLE BLOCK CAPACITY (lb)	BEARING BLOCK & WOOD BEARING ALLOWABLE			
					CASE 1 (lb)	CASE 1 (FT-IN-16THS)	CASE 2 (LB)	CASE 2 (FT-IN-16THS)
2x4 BOTTOM CHORD 2 ROWS @ 3" O.C. (8 TOTAL NAILS)	SP	4661	5127	976	5637	0-6-10	6103	0-7-3
	DF	5156	5672	893	6050	0-6-7	6565	0-7-0
	HF	3341	3675	775	4116	0-6-12	4451	0-7-5
	SPF	3506	3857	758	4265	0-6-11	4615	0-7-4
2x6 BOTTOM CHORD 3 ROWS @ 3" O.C. (12 TOTAL NAILS)	SP	4661	5127	1464	6125	0-7-4	6592	0-7-12
	DF	5156	5672	1340	6496	0-6-15	7012	0-7-8
	HF	3341	3675	1163	4504	0-7-7	4838	0-7-15
	SPF	3506	3857	1138	4644	0-7-5	4994	0-7-13
2x8 BOTTOM CHORD 4 ROWS @ 3" O.C. (16 TOTAL NAILS)	SP	4661	5127	1952	6613	0-7-13	7080	0-8-6
	DF	5156	5672	1787	6943	0-7-6	7459	0-7-15
	HF	3341	3675	1550	4892	0-8-1	5226	0-8-10
	SPF	3506	3857	1517	5023	0-7-14	5374	0-8-7

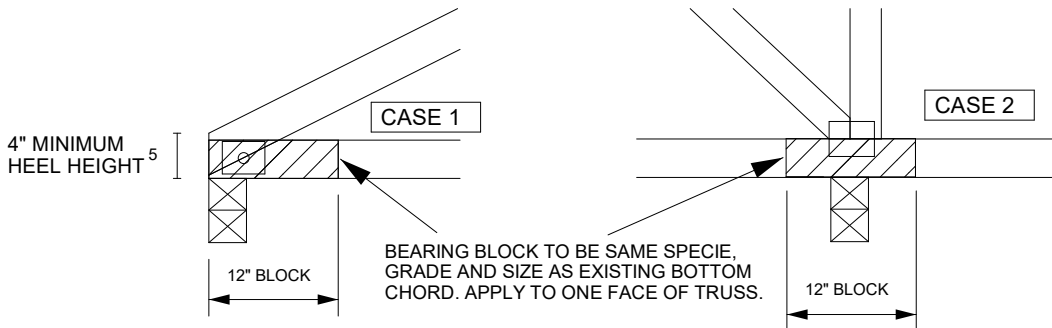

**NOTES:**

1. USE LOWER  $F_{c\perp}$  value OF TOP PLATE OR TRUSS WOOD SPECIES.
2. USE 1.5" END DISTANCE AND SPACE ROWS OF NAILS EQUALLY WITHIN THE DEPTH OF THE BLOCK, SEE DETAIL ABOVE .
3. NAILS DESIGNATED ARE 10d (0.131" X 3")
4. BEARING FACTOR OF 1.1 APPLIED, SEE CASE 2 DETAIL, END OF BLOCK MORE THAN 3" FROM THE END OF THE CHORD MEMBER.
5. BEARING BLOCK SHALL NOT BE CLIPPED FOR DETAIL TO BE VALID.
6. JOINT SPLICE IS PERMITTED IN A CASE 2 CONDITION.

**LOADS BASED ON FOLLOWING  $F_c$  PERPENDICULAR VALUES:**

- SP = 565 psi
- DF = 625 psi
- HF = 405 psi
- SPF = 425 psi

NOTE: VALUES DO NOT INCLUDE MSR LUMBER WITH "E" VALUES GREATER THAN 1,900,000 PSI OR NON-DENSE GRADE LUMBER.