

**Technical Bulletin
THD46 Truss Hanger
MASONRY APPLICATION**

The *THD46 Truss Hanger* can be used to connect 4x6 or 4x8 plated wood trusses, rafters, or joists to masonry wall structures. Allowable loads are based on proper use of fasteners installed per manufacturer's specifications.

- Masonry screw shall be 3/16" diameter Powers® Fasteners Tapper+.
- Minimum masonry screw embedment shall be 1-1/4".
- Install masonry screws **only** in **shaded fastener holes** as indicated on illustration to achieve listed loads in the table below.

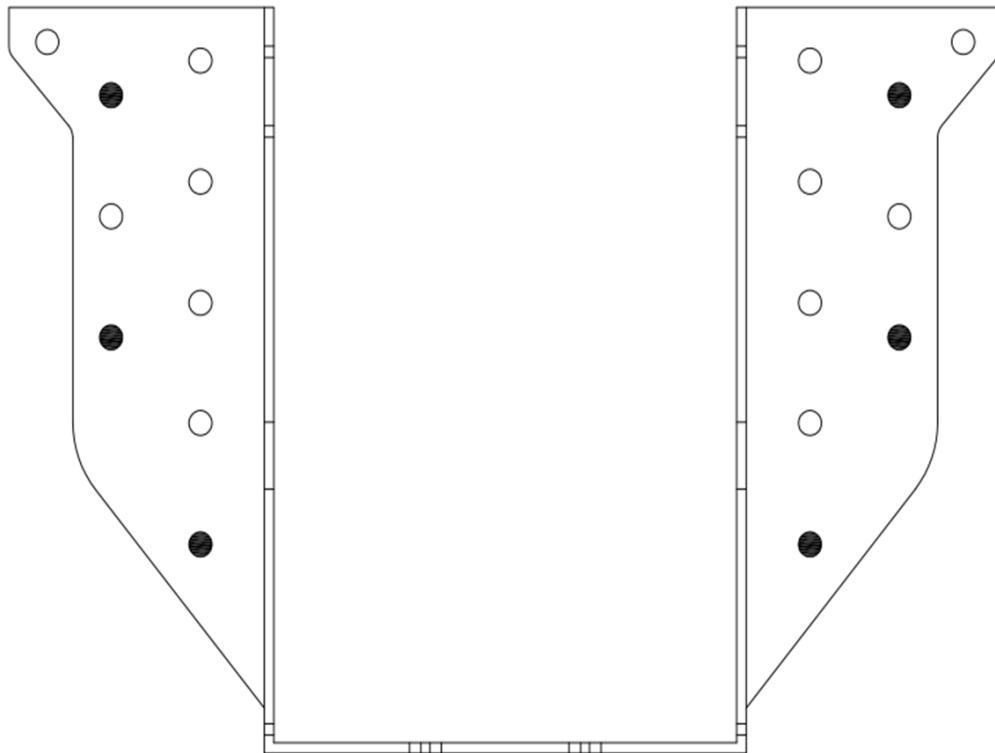

USP Stock No	Description	Steel Gauge	Fastener Schedule ²				DF/SP Allowable Load (lbs) ^{1,3}		
			Wood		Masonry		Down	Uplift ⁵	Field Uplift ⁶
			Qty	Size ⁴	Qty	Size	100%	160%	160%
THD46	4 x 6-8 Face Mount Truss Hanger	14	12	10d	6	3/16"	840	560	840

1) Allowable loads assume the use of Powers® Fasteners 3/16" Tapper+™ with minimum embedment of 1-1/4".

2) Fasteners to be installed per manufacturer's recommendations.

3) Allowable loads based on specified holes being filled.

4) Minimum embedment shall be 1-1/2" for 10d nails.

5) Allowable uplift when the uppermost masonry fasteners have an edge distance less than 2" from the top of the masonry wall.

6) Allowable uplift when the uppermost masonry fasteners have an edge distance greater than 2" from the top of the masonry wall.