



## TRUSS CRITERIA:

LOADING: 40-10-0-10  
 DURATION FACTOR: 1.15  
 SPACING: 24" O.C.  
 TOP CHORD: 2x4 OR 2x6  
 PITCH: 4/12 - 12/12  
 HEEL HEIGHT: STANDARD HEEL UP TO 12" ENERGY HEEL  
 END BEARING CONDITION

## NOTES:

1. ATTACH 2x\_ SCAB (MINIMUM NO.2 GRADE SPF, HF, SP, DF) TO ONE FACE OF TRUSS WITH TWO ROWS OF 10d (0.131" X 3") NAILS SPACED 6" O.C.
2. THE END DISTANCE, EDGE DISTANCE, AND SPACING OF NAILS SHALL BE SUCH AS TO AVOID UNUSUAL SPLITTING OF THE WOOD.
3. WHEN NAILING THE SCABS, THE USE OF A BACKUP WEIGHT IS RECOMMENDED TO AVOID LOOSENING OF THE CONNECTOR PLATES AT THE JOINTS OR SPLICES.

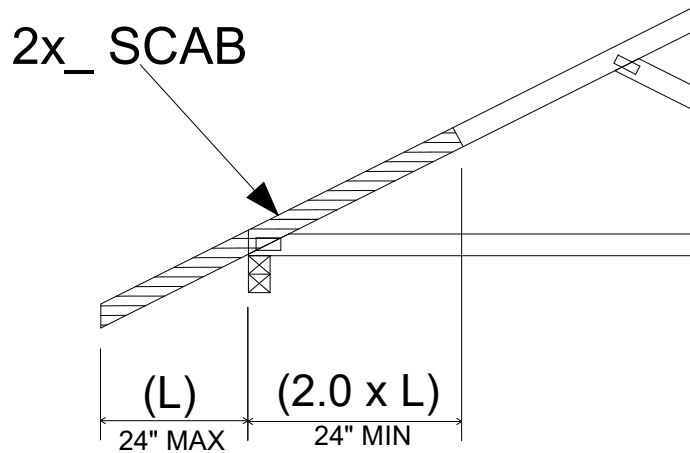

NOTE: TRUSS BUILT WITHOUT AN OVERHANG.  
 THIS DETAIL IS NOT TO BE USED WHEN  
 OVERHANG HAS BEEN BROKEN OFF.

## IMPORTANT

This detail to be used only with trusses (spans less than 40') spaced 24" o.c. maximum and having pitches between 4/12 and 12/12 and total top chord loads not exceeding 50 psf.  
 Trusses not fitting these criteria should be examined individually.

REFER TO INDIVIDUAL TRUSS DESIGN  
 FOR PLATE SIZES AND LUMBER GRADES