

CONCRETE SCREW

(CSHS / CSFP / CSFPW) MECHANICAL ANCHORS

MiTek[®] PRO SERIES[™]

**EPOXY
COATED**



- ⇒ For use in light-duty uncracked concrete applications
- ⇒ Installation using standard ANSI tolerance drill bits
- ⇒ Multiple head styles available for a majority of fixture anchoring needs
- ⇒ Thread design allows for reduced installation torque and increased pullout performance
- ⇒ White finish screws ideal for a discreet appearance

HEX



PHILLIPS



PHILLIPS



CONCRETE SCREW (CSHS / CSFP / CSFPW) MECHANICAL ANCHORS

MiTek[®] PRO SERIES™

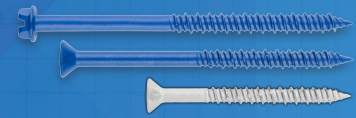

APPLICATIONS

- Metal door frames and thresholds
- Interior electrical applications
- Light fixtures
- Window frame installations
- Hand rails
- Wood furring strip attachment

INSTALLATION



Drill a hole into the base material of the correct diameter and depth using a drill bit that meets the requirements of ANSI B212.15-1994.

Remove dust and debris from hole using a blow bulb, compressed air or vacuum to remove the loose particles left from drilling.

Select the socket or Phillips bit to be used. Insert the head of the anchor into the hex head socket or Phillips head driver. Set the drill motor to the "rotation only" mode.

Place the point of the anchor through the fixture into the predrilled hole and drive the anchor in one steady continuous motion until it is fully seated on the fixture at the proper embedment. **DO NOT OVERDRIVE.**

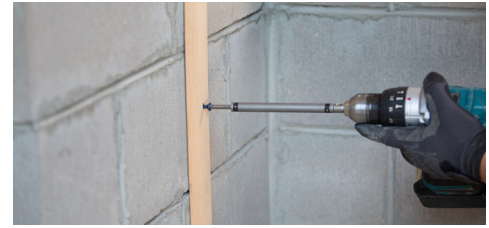

See detailed installation and design instructions at MiTek-US.com to ensure proper installation and to reduce risk failure which could result in injury and/or property damage. MiTek will not be liable for any anchor failure due to defective substrate material or improper installation

LOAD TABLE

Size (in)	Head Style	Color	MiTek Stock No.	Ref. No.	Bit Size	Min. Anchor Embed. (in)	Min. Edge Distance (in)	Uncracked Concrete		Ordering MiTek Stock No.	Pieces per Selling Unit	Selling Unit per Master Carton
								Allowable Tension (lbs)	Allowable Shear (lbs)			
3/16 x 1-1/4	Phillips Flat	Blue	CSFP316114	TTN18114PF, TTN2-18114PF	#2	1-1/8	1-1/8	190	335	CSFP316114-CR8	8	8
										CSFP316114-CR25	25	6
										CSFP316114-CR75	75	6
										CSFP316114-R225	225	6
	Hex Slot	Blue	CSHS316114	TTN18114H, TTN2-18114H	1/4"	1-1/8	1-1/8	190	335	CSHS316114-CR8	8	8
										CSHS316114-CR75	75	6
3/16 x 1-3/4	Phillips Flat	Blue	CSFP316134	TTN18134PF, TTN2-18134PF	#2	1-5/8	1-1/8	425	350	CSFP316134-CR8	8	8
										CSFP316134-CR25	25	6
										CSFP316134-CR75	75	6
										CSFP316134-R225	225	6
	Hex Slot	White	CSFPW316134	TTNW18134PF, TTN2W18134PF	#2	1-5/8	1-1/8	425	350	CSFPW316134-CR75	75	6
										Hex Slot	Blue	CSHS316134

- Example Allowable Stress Design (ASD) values include an approximate safety factor of 4.
 - Values based on single anchor installations and do not consider critical edge distance or spacing. For full design information refer to MiTek-US.com.
 - Edge distance based on ACI318-14 section 17.7, designer shall verify distance is twice the maximum aggregate size and comply with section 20.6.1.
 - Values in table assume concrete strength $f'_c = 4,000$ psi.
- NOTE:** 3/16" diameter requires 5/32" drill bit.

CONTINUED ON NEXT PAGE →

CUSTOMER SERVICE: 1-800-328-5934 | MiTek-US.com

©2020 MITEK. ALL RIGHTS RESERVED. #2587-CS 8/2020

CONCRETE SCREW (CSHS / CSFP / CSFPW) MECHANICAL ANCHORS

MiTek[®] PRO
SERIES™

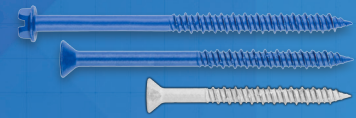

LOAD TABLE

Size (in)	Head Style	Color	MiTek Stock No.	Ref. No.	Bit Size	Min. Anchor Embed. (in)	Min. Edge Distance (in)	Uncracked Concrete		Ordering MiTek Stock No.	Pieces per Selling Unit	Selling Unit per Master Carton
								Allowable Tension (lbs)	Allowable Shear (lbs)			
3/16 x 2-1/4	Phillips Flat	Blue	CSFP316214	TTN18214PF, TTN2-18214PF	#2	2	1-1/8	635	350	CSFP316214-CR8	8	8
										CSFP316214-CR25	25	6
		White	CSFPW316214	TTNW18214PF, TTN2W18214PF	#2	2	1-1/8	635	350	CSFP316214-CR75	75	6
										CSFPW316214-R225	225	4
3/16 x 2-3/4	Phillips Flat	Blue	CSFP316234	TTN18234PF, TTN2-18234PF	#2	2	1-1/8	635	350	CSFP316234-CR8	8	8
										CSFP316234-CR25	25	6
		White	CSFPW316234	TTNW18234PF, TTN2W18234PF	#2	2	1-1/8	635	350	CSFP316234-CR75	75	6
										CSFPW316234-R225	225	4
	Hex Slot	Blue	CSHS316234	TN18234H, TTN2-18234H	1/4"	2	1-1/8	635	350	CSFPW316234-CR25	25	6
										CSHS316234-CR75	75	6
3/16 x 3-1/4	Phillips Flat	Blue	CSFP316314	TTN18314PF, TTN2-18314PF	#2	2	1-1/8	635	350	CSFP316314-CR8	8	8
										CSFP316314-CR75	75	6
1/4 x 1-1/4	Phillips Flat	Blue	CSFP014114	TTN25114PF, TTN2-25114PF	#3	1-1/8	1-1/2	200	365	CSFP014114-CR8	8	8
										CSFP014114-CR75	75	6
	Hex Slot	Blue	CSHS014114	TTN2-25114H	5/16"	1-1/8	1-1/2	200	365	CSHS014114-CR8	8	8
										CSHS014114-R225	225	6
1/4 x 1-3/4	Phillips Flat	Blue	CSFP014134	TTN25134PF, TTN2-25134PF	#3	1-5/8	1-1/2	480	585	CSFP014134-CR8	8	8
										CSFP014134-CR25	25	6
		White	CSFPW014134	--	#3	1-5/8	1-1/2	480	585	CSFPW014134-CR8	8	8
	Hex Slot	Blue	CSHS014134	TTN2-25134H	5/16"	1-5/8	1-1/2	480	585	CSHS014134-CR8	8	8
										CSHS014134-CR75	75	6
										CSHS014134-R225	225	4
1/4 x 2-1/4	Phillips Flat	Blue	CSFP014214	TTN25214PF, TTN2-25214PF	#3	2-1/8	1-1/2	815	585	CSFP014214-CR8	8	8
										CSFP014214-CR75	75	6
	Hex Slot	Blue	CSHS014214	TTN25214H, TTN2-25214H	5/16"	2-1/8	1-1/2	815	585	CSHS014214-CR8	8	8
										CSHS014214-CR75	75	6
1/4 x 2-3/4	Phillips Flat	Blue	CSFP014234	TTN25234PF, TTN2-25234PF	#3	2-1/8	1-1/2	815	585	CSFP014234-CR8	8	8
										CSFP014234-CR25	25	6
		White	CSFPW014234	TTNW25234PF, TTN2W25234PF	#3	2-1/8	1-1/2	815	585	CSFP014234-CR75	75	6
										CSFPW014234-R150	150	4
	Hex Slot	Blue	CSHS014234	TTN25234H, TTN2-25234H	5/16"	2-1/8	1-1/2	815	585	CSFPW014234-CR8	8	8
										CSFPW014234-CR75	75	6
										CSHS014234-CR8	8	8
										CSHS014234-CR25	25	6
										CSHS014234-CR75	75	6
										CSHS014234-R150	150	4

- 1) Example Allowable Stress Design (ASD) values include an approximate safety factor of 4.
 - 2) Values based on single anchor installations and do not consider critical edge distance or spacing. For full design information refer to MiTek-US.com.
 - 3) Edge distance based on ACI318-14 section 17.7, designer shall verify distance is twice the maximum aggregate size and comply with section 20.6.1.
 - 4) Values in table assume concrete strength $f'_c = 4,000$ psi.
- NOTE:** 3/16" diameter requires 5/32" drill bit; 1/4" diameter requires 3/16" drill bit.

CONTINUED ON NEXT PAGE →

CONCRETE SCREW (CSHS / CSFP / CSFPW) MECHANICAL ANCHORS

MiTek[®] PRO SERIES[™]

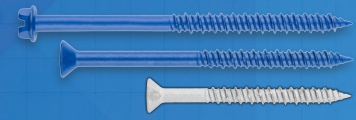

LOAD TABLE

Size (in)	Head Style	Color	MiTek Stock No.	Ref. No.	Phillips Bit	Min. Anchor Embed. (in)	Min. Edge Distance (in)	Uncracked Concrete		Ordering MiTek Stock No.	Pieces per Selling Unit	Selling Unit per Master Carton
								Allowable Tension (lbs)	Allowable Shear (lbs)			
1/4 x 3-1/4	Phillips Flat	White	CSFPW014314	TTNW25314PF, TTN2W25314PF	#3	2-1/8	1-1/2	815	585	CSFPW014314-CR75	75	6
	Hex Slot	Blue	CSHS014314	TTN25314H, TTN2-25314H	5/16"	2-1/8	1-1/2	815	585	CSHS014314-CR8	8	8
1/4 x 3-3/4	Phillips Flat	Blue	CSFP014334	TTN25334PF, TTN2-25334PF	#3	2-1/8	1-1/2	815	585	CSFP014334-CR8	8	6
										CSFP014334-CR25	25	6
										CSFP014334-CR75	75	6
	Hex Slot	Blue	CSHS014334	TTN25334H, TTN2-25334H	5/16"	2-1/8	1-1/2	815	585	CSHS014334-CR8	8	6
										CSHS014334-CR75	75	6
										CSFPW014334-CR75	75	6
1/4 x 4	Phillips Flat	Blue	CSFP014400	TTN25400PF, TTN2-25400PF	#3	2-1/8	1-1/2	815	585	CSFP014400-CR8	8	6
										CSFP014400-CR50	50	6
1/4 x 4	Hex Slot	Blue	CSHS014400	TTN25400H, TTN2-25400H	5/16"	2-1/8	1-1/2	815	585	CSHS014400-CR25	25	6
										CSHS014400-CR75	75	6
1/4 x 5	Hex Slot	Blue	CSHS014500	TTN25500H, TTN2-25500H	5/16"	2-1/8	1-1/2	815	585	CSHS014500-CR25	25	6

- 1) Example Allowable Stress Design (ASD) values include an approximate safety factor of 4.
 - 2) Values based on single anchor installations and do not consider critical edge distance or spacing. For full design information refer to MiTek-US.com.
 - 3) Edge distance based on ACI318-14 section 17.7, designer shall verify distance is twice the maximum aggregate size and comply with section 20.6.1.
 - 4) Values in table assume concrete strength $f'_c = 4,000$ psi.
- NOTE:** 1/4" diameter requires 3/16" drill bit.

CONCRETE SCREW INSTALLATION KIT (CSKT-6)

- Rapid Change drill bit and drive tool
- Combination drill bit with slide over driver extension for quick work
- Works with any hammer drill

Screw Dia. (in)	Drill Bit Dia. (in)	Hex Bit (in)	Phillips Bit
3/16	5/32	1/4	#2
1/4	3/16	5/16	#3

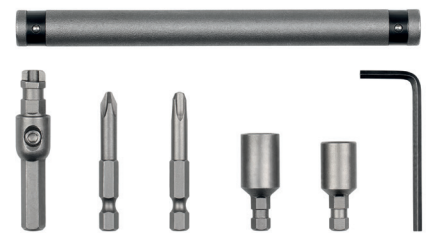

KIT INCLUDES: Driver Sleeve / Drill Bit Adapter / #2 and #3 Phillips Bits / 1/4" and 5/16" Hex Drivers / Hex Key / Carry Pouch

INSTALLATION

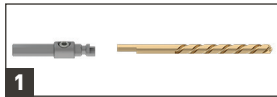

Place the correct MiTek[®] drill bit in drill adapter and tighten set with included hex key.

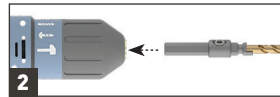

Secure drill adapter into 3/8" - 1/2" chuck of hammer drill.



Attach desired Hex or Phillips bit into end of sleeve.

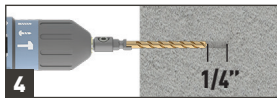

Drill hole 1/4" deeper than depth of anchor embedment and clean dust from hole.

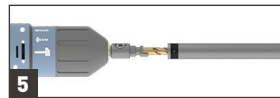

Connect driver sleeve over drill bit and secure onto drill adapter.

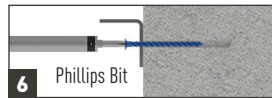

With the appropriately attached bit drive the MiTek screw into the predrilled hole.



With the appropriately attached bit drive the MiTek screw into the predrilled hole.