

Welded Top Flange

Specialty Options

- Weld sizes and lengths shown on chart.
- Weld-on applications produce maximum allowable load listed. **Uplift loads do not apply to this application.**
- All welding should be done in accordance with the American Welding Society (AWS) Standard by a certified welder.
Caution: Welding galvanized steel may produce harmful fumes and should only be performed in well-ventilated environments.

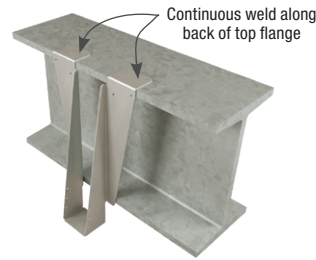

Typical top flange welded installation

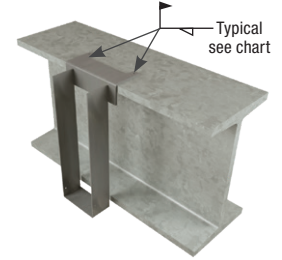

Typical top angle welded installation

Top Angle Weld Length Chart

MiTek USP Welded Hanger Series	Weld Length
SW	3"
BPH, FWH, HBPH, PHM, SWH	4"
FWHBP, FWHFM, FWHH, KLB, KHW, PHXU	6"
KB, KGB, KHGB, KHHB, KGLS, KGLST, KGLT, KHGLS, KHGLST	8"
HLBH, KHGLT	10"

Top Angle Steel Gauge	Weld Size
14 - 10 gauge	1/8"
7 gauge	3/16"
3 gauge	1/4"

Weld shall be distributed evenly.

Part Number System

Part Numbers assigned to TFL, THO, IHFL, IHF, THFI and THF I-Joist hangers reveal the I-Joist sizes to be used with the specific hanger. This guide will teach you how to recognize I-Joist dimensions in the part numbers.

1st, 3rd, and sometimes 4th digits are whole numbers
(This example denotes 2 and 11)
4th digit may be part of a decimal –

TFL 23118

2nd and 5th digits are decimals
(see guide below)
(This example denotes .3125
[5/16] and .875 [7/8])
5th digit may be (0) or dropped if height is even

Part Number Guide for Decimals

1 = .125	or	1/8 inch
2 or 25 = .25	or	1/4 inch
3 = .3125	or	5/16 inch
5 = .5	or	1/2 inch
6 = .625	or	5/8 inch
7 = .75	or	3/4 inch
8 = .875	or	7/8 inch

THO35925-2

THO
Letters refer to Hanger Series
ex.: THO

35
First (2) Digits refer to Member Width
ex.: 3.5 inches

925
Last (2) or (3) Digits refer to Member Height
ex.: 9.25 inches

-2
Digits after Dash refer to Number of Plies
ex.: 2-ply

Some Examples:

THO15950 1-1/2" x 9-1/2"

IHFL17925..... 1-3/4" x 9-1/4"

THO16925-2 double 1-5/8" x 9-1/4"

THF23925-2..... double 2-5/16" x 9-1/4"

Note: MiTek's USP Product Catalog lists a range of heights for IHFL/IHF hangers. Face mount hangers can usually accommodate more than one I-Joist height. The hanger height must be tall enough to support the top chord of the I-Joist to eliminate web stiffener requirements for lateral stability. The IHFL/IHF hanger must be a minimum of 60% of the joist height.