

The FWHFM hanger fastens to the wide face of a balloon framed SCL column thereby eliminating the additive perpendicular-to-grain bearing stresses in the wall top and bottom plates seen with platform framing. The advanced design allows you to install the hangers **before** the gypsum wallboard (drywall) is attached, allowing your project to be completely framed-up and weather-tight before the gypsum wallboard sheathing shows up on site.

### 2 Hour Fire-Rating

FWH hangers are tested per ASTM E814 standards. When installed on one side of a maximum 2 hour fire-rated wall assembly, the penetration of the MiTek FWH Fire Wall Hanger through the gypsum wallboard will not reduce the fire resistive rating of the 2 hour fire resistive assembly.

#### Features and Benefits:

- Face mount hanger design installs with nails
- Attaches to the wide face of columns
- Hanger web accommodates 2-ply of 5/8" gypsum wallboard
- Achieve full table loads with or without drywall installation

**Materials:** 12 gauge

**Finish:** Primer

**Options:** See Specialty Options chart on page 201

**Patents:** Pending

#### Installation:

- Install the face of hanger flanges tight to SCL column/framing.
- The end of the truss/joist should measure 1-5/8" from the face of the supporting column.
- The truss/joist should bear fully on the FWH seat with a gap no greater than 1/8" between the end of the supported member and the hanger.
- **Gypsum Wallboard Installation** – Use the FWH-T template to slot cut the gypsum wallboard. See FWH-T Template Sequence. Slide the gypsum wallboard into position and fasten to the framing members meeting the minimum requirements specified by code.

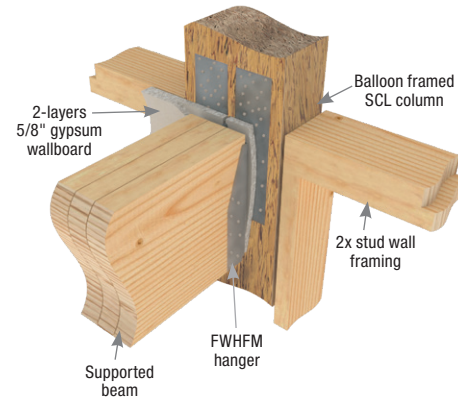

Typical FWHFM installation

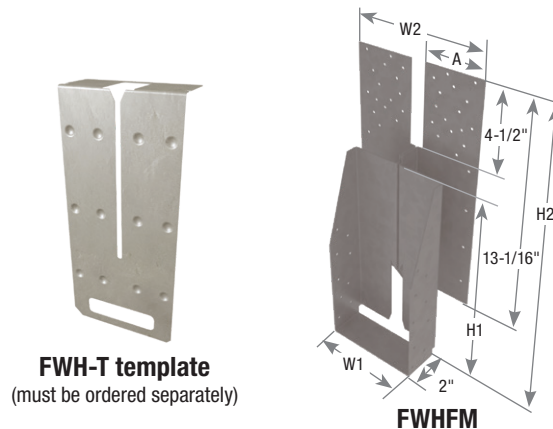

Copyright © 2020 MiTek Industries, Inc. All Rights Reserved

### FWH-T Template Installation Sequence

1) Align the FWH-Template slot with the mark in the gypsum wallboard and engage the prongs into edge of gypsum wallboard

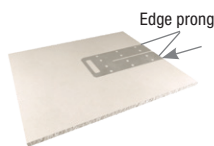

2) Rotate the template and press down on the end to engage the corner prongs

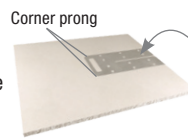

3) Run the gypsum wallboard cutter down the template to cut the slot

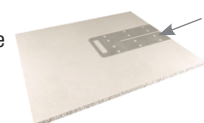

Continued on next page

Joist Size (in)	MiTek USP Stock No.	Ref. No.	Steel Gauge	Dimensions (in)						Fastener Schedule <sup>3</sup>				DF/SP Allowable Loads (Lbs.)				Code Ref.	
				W1	W2	H1	H2	D	A	Header		Joist		Download <sup>1</sup>			Uplift 160% <sup>2</sup>		
										Face Qty	Type	Qty	Type	100%	115%	125%			
3-1/2 x 9-1/4	FWHFM35925					9-1/16	13-9/16												
3-1/2 x 9-1/2	FWHFM3595					9-5/16	13-13/16												
3-1/2 x 11-7/8	FWHFM35118					11-11/16	16-3/16												
3-1/2 x 14	FWHFM3514					13-13/16	18-5/16												
3-1/2 x 16	FWHFM3516	--	12	3-9/16	4-11/16	15-13/16	20-5/16	2	2-1/16	40	10d	18	10d x 1-1/2	5960	6625	7050	2990	--	
3-1/2 x 18	FWHFM3518					17-13/16	22-5/16												
3-1/2 x 20	FWHFM3520					19-13/16	24-5/16												
3-1/2 x 22	FWHFM3522					21-13/16	26-5/16												
3-1/2 x 24	FWHFM3524					23-13/16	28-5/16												
4 - 4-3/16 x 9-1/4	FWHFM42925					9-1/16	13-9/16												
4 - 4-3/16 x 9-1/2	FWHFM4295					9-5/16	13-13/16												
4 - 4-3/16 x 11-7/8	FWHFM42118					11-7/16	15-15/16												
4 - 4-3/16 x 14	FWHFM4214					13-5/8	18-1/8												
4 - 4-3/16 x 16	FWHFM4216	--	12	4-3/16	5-5/16	15-5/8	20-1/8	2	2-3/8	40	10d	18	10d x 1-1/2	5960	6625	7050	2990		
4 - 4-3/16 x 18	FWHFM4218					17-5/8	22-1/8												
4 - 4-3/16 x 20	FWHFM4220					19-5/8	24-1/8												
4 - 4-3/16 x 22	FWHFM4222					21-5/8	26-1/8												
4 - 4-3/16 x 24	FWHFM4224					23-5/8	28-1/8												
5-1/4 x 9-1/4	FWHFM52925					9-1/16	13-9/16												
5-1/4 x 9-1/2	FWHFM5295					9-5/16	13-13/16												
5-1/4 x 11-7/8	FWHFM52118					11-5/8	16-1/8												
5-1/4 x 14	FWHFM5214					13-13/16	18-5/16												
5-1/4 x 16	FWHFM5216	--	12	5-3/8	6-1/2	15-13/16	20-5/16	2	3	40	10d	18	10d x 1-1/2	5960	6625	7050	2990	--	
5-1/4 x 18	FWHFM5218					17-13/16	22-5/16												
5-1/4 x 20	FWHFM5220					19-23/28	24-5/16												
5-1/4 x 22	FWHFM5222					21-13/16	26-5/16												
5-1/4 x 24	FWHFM5224					23-13/16	28-5/16												
7 x 11-7/8	FWHFM71118					11-11/16	16-3/16												
7 x 14	FWHFM7114					13-13/16	18-5/16												
7 x 16	FWHFM7116					15-13/16	20-5/16												
7 x 18	FWHFM7118	--	12	7-1/8	8-1/4	17-13/16	22-5/16	2	3-7/8	40	10d	18	10d x 1-1/2	5960	6085	6085	2990		
7 x 20	FWHFM7120					19-13/16	24-5/16												
7 x 22	FWHFM7122					21-13/16	26-5/16												
7 x 24	FWHFM7124					23-13/16	28-5/16												

- 1) Download allowable load is for attachment to the wide face of a supporting column.
- 2) Uplift loads have been increased 60% for wind or seismic loads. No further increase shall be permitted.

**Specialty Options Chart** – Refer to Specialty Options pages 320-321 for additional details.

Option	Skewed <sup>1</sup>
Range	1° to 70°
Allowable Loads	70% of table load
Ordering	Add <i>SK</i> , angle required, right ( <i>R</i> ) or left ( <i>L</i> ), and square cut ( <i>SQ</i> ) to product number. Ex. FWHFM5214_SK60L_SQ

- 1) Skewed hangers with skews greater than 15° may have all joist nailing on outside flange.